

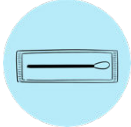

INSTRUCTIONS FOR STD SWAB SAMPLE COLLECTION

PLEASE READ ALL INSTRUCTIONS BEFORE COLLECTING YOUR SAMPLE

YOUR KIT CONTAINS



x 1 Swab



x 1 tube with liquid

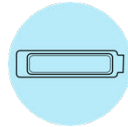

x 1 plastic case



x 1 return bag

BEFORE TAKING YOUR SAMPLE

ORDER NO.	DATE	CUSTOMER STAGE ID	REC	LAB STAGE PROC	RES SWAB	RESULT
8833	04/2/2020	Enter Date Here Tracking Number Request Mail	<input type="checkbox"/>	<input type="checkbox"/>	<input type="checkbox"/>	

Login into your account on www.medicinesonline.org.uk and activate your sample by clicking on **SAMPLE ACTIVATION AND RESULT**, then select your test day, enter your **pre-paid tracking number** and the **tube number** (see under barcode) then click on **SAVE**.

TAKING YOUR SAMPLE

1.



Wash your hands and remove the swab from the package without touching the end of the swab.

2.

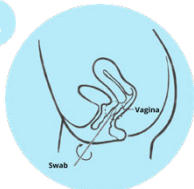

Female: Insert the swab 3-5cm into your vagina and turn gently for 20 seconds. Remove carefully without snapping the swab. **DO NOT URINATE AT LEAST 1 HOUR BEFORE TAKING THE SAMPLE.**



Male: Insert the swab 2-3cm into your urethra and turn gently for 20 seconds. Remove carefully without snapping the swab. **DO NOT URINATE AT LEAST 1 HOUR BEFORE TAKING THE SAMPLE.**

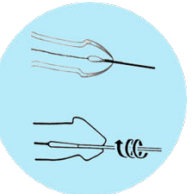



INSTRUCTIONS FOR STD SWAB SAMPLE COLLECTION

3.



Without putting down the swab, unscrew the cap from the sample tube, carefully insert the end of the swab into the tube and break it inside the sample tube.

4.

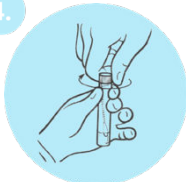

Once the part of the swab is broken inside the sample tube, please firmly screw the cap.

5.

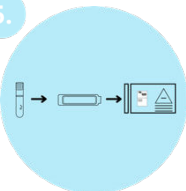

Place the sample tube into the plastic case, seal tightly and put it inside the return bag provided.

6.



Make a note of the return tracking number under the barcode on the postal tracking label, as shown above. Keep this in a safe place for future reference. Post your sample in a Royal Mail Priority Post box on the same day it was taken.

7.



Before you post your sample, double-check that you have:

- Activated your sample.
- Pushed the collection tube lid until it clicks.
- Kept a record of the tracking number.

Intended Use

Liquid VCM™ recovers viruses like Chlamydia, Mycoplasma, Gonorrhoea, Ureaplasma and HPV. Small vial with 1.0ml medium.

Compatible with molecular and cell culture techniques.

This product contains no hazardous constituents, or the concentration of all chemical constituents are below the regulatory threshold limits described by European directive 1272/2008/EC and the Occupational Safety Health Administration Hazard Communication Standard 29 CFR 1910/1200 and the Canadian Workplace Hazardous Materials Information System (WHMIS).

Safety Precautions

Only use the equipment provided to take your sample. Kit to be used for intended use only. Keep out of reach of children.

Warnings

Do not open the collection tube until time of intended use.

Contraindications

Not to be used by persons under the age of 18 years old.

Storage

Do not expose to direct sunlight. Store product at 5°C to 25°C. Store in cool, dry conditions.

MWE Corsham UK SN13 9RT



Advena Ltd, Swatar 4013 MALTA

Inbox of symbols

	Consult instruction for use
	Use by
	For <i>in vitro</i> diagnostic use only
	Manufacturer
	Authorized Representative
	Do not reuse
	Catalog#
	Lot Number
	Keep out of sunlight
	Store at 5°C to 25°C
	Sterile R
	Biohazard